

**ITEM 4. STREET EVENTS – TEMPORARY ROAD CLOSURE – KENSINGTON
STREET CHIPPENDALE**

FILE NO: 2015/529790

RECOMMENDATION

It is recommended that the Committee endorse the temporary road closure of Kensington Street, Chippendale, between Outram and Dwyer Streets, on Sunday 13 December 2015 between 7am and 12 midnight. The road would be closed for a Chippendale community event, subject to the following conditions:

- (A) The Applicant must comply with the temporary road closure conditions as stipulated in Schedule B of this Agenda.
- (B) The Applicant must contact Redfern Police to discuss deployment of user pay police for the event.
- (C) The Applicant must contact the City's Venue Management Unit to discuss the event.
- (D) The Applicant must provide a telephone number of the supervisor responsible for the proposed event and include contact details in the notification letters to be distributed to affected stakeholders.

DECISION

BACKGROUND

The Chippendale Creative Precinct has applied to temporary close Kensington Street, Chippendale, between Outram and Dwyer Streets, on Sunday 13 December 2015 between 7am and 12 midnight. The road would be closed for a Chippendale community event.

The proposed closure would be limited to Kensington Street, between Outram and Dwyer Streets which ensures uninterrupted access to the Old Clare Hotel.

COMMENTS

The Chippendale community event requires the closure of City streets and traffic detours around the event area.

The events have been created to draw together artists, performers, creative industries, eateries and galleries of the area.

The Applicant has provided a site-specific Traffic Control Plan that includes details of barricades, signs, flagmen and other traffic devices to implement the proposed road closures.

Temporary Road Closure – between 7am and 12 midnight on Sunday 13 December 2015 - Kensington Street, Chippendale, between Outram and Dwyer Streets.

The City has not received any traffic related complaints about previous events.

The temporary road closure will not affect pedestrian access to properties as local access will be provided at all times and alternative traffic access routes are available nearby.

CONSULTATION

The Applicant will be required to notify affected stakeholders as stipulated in Schedule B.

FINANCIAL

All costs associated with the proposed closures will be borne by the Applicant.

ATTACHMENTS

Street Events – Temporary Road Closure – Kensington Street Chippendale

Joseph Gomes, Area Traffic Engineer

TCP EFFECTIVE AS PER TIMES/DATES AS PER COUNCIL APPROVAL

NOTES:

* Deliveries to businesses within the closures will be granted during closure.





* Emergency Services access maintained.

* If access is required a TC will escort the vehicle to the location and back.

Manifest

- 8 x barrier board
- 2 x prepare to stop T1-18
- 2 x road closed T2-4
- 1 x ROAD CLOSED AHEAD MMS-ADV-33 MMS-ADV-33
- 2 x traffic controller
- 2 x Traffic Controller Symbolic

Legend

-  barrier board
-  prepare to stop T1-18
-  traffic controller
-  Traffic Controller Symbolic

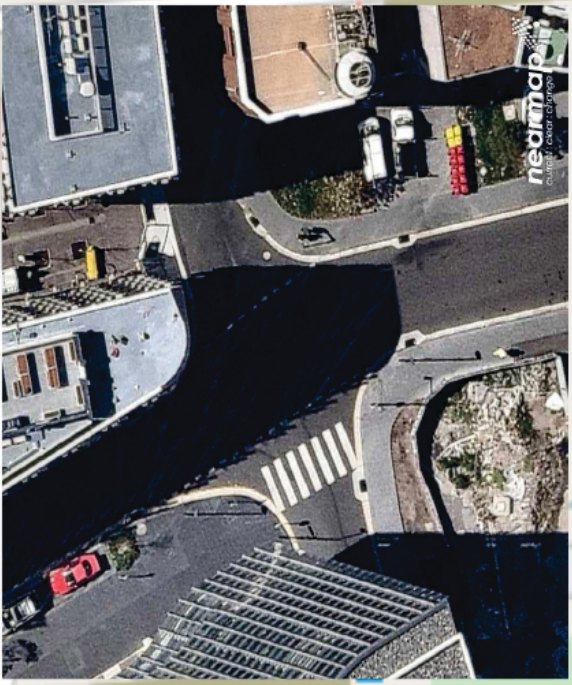

Date: 11/09/2015 **Project:** WEEKEND MARKETS **TCP:** 3422
Location: Chippendale **Ver:** 1
Comments:
 * Traffic Controllers on duty at all times on road closures.
 * Event infrastructure must be able to be removed to allow for emergency vehicle access if needed. Plan not drawn to scale!
 Consulted: P Danks, D Caple, C Toward
 Copyright Traffic Plan Professionals Pty Ltd 2015

Traffic Plan
 Professionals Pty Ltd
 Peck Danks
 M: 0407 29 29 88
 O: +61 2 8002 0919
 F: +61 2 8002 0914
 ACN: 000 546 618
 www.trafficplanprofessionals.com.au

Design & Support Traffic Control Plan
 Card No: 232016073

Transport NSW
 Select a Ready Traffic Control Plan
 Card No: 232004509

Peck Danks
 Expire Date: 03/03/2017

Peck Danks
 Expire Date: 14/02/2017

Traffic Plan Professionals Pty Ltd accepts no liability for implementation/execution unless carried out by authorised TPE staff. TCP installed by RMS Authorised Yellow Card Holder only.

